

EAS22860

REMOVING THE HANDLEBAR

1. Stand the vehicle on a level surface.

EWA13120

WARNING

Securely support the vehicle so that there is no danger of it falling over.

2. Remove:

- Handlebar grip “1”

TIP

Blow compressed air between the left handlebar and the handlebar grip, and gradually push the grip off the handlebar.

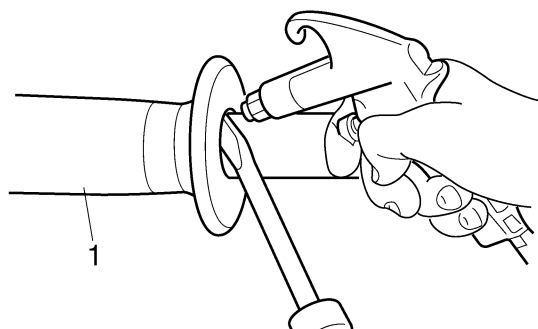

EAS22880

CHECKING THE HANDLEBAR

1. Check:

- Handlebar “1”
Bends/cracks/damage → Replace.

EWA13690

WARNING

Do not attempt to straighten a bent handlebar as this may dangerously weaken it.

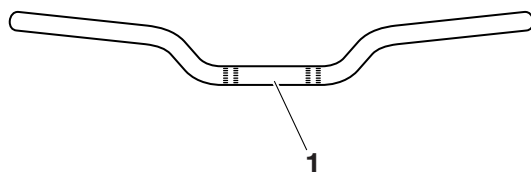

EAS22921

INSTALLING THE HANDLEBAR

1. Stand the vehicle on a level surface.

EWA13120

WARNING

Securely support the vehicle so that there is no danger of it falling over.

2. Install:

- Handlebar “1”
- Upper handlebar holder “2”



Upper handlebar holder bolt
23 Nm (2.3 m·kgf, 17 ft·lbf)

ECA14250

NOTICE

- First, tighten the bolts on the front side of the handlebar holder, and then on the rear side.
- Turn the handlebar all the way to the left and right. If there is any contact with the fuel tank, adjust the handlebar position.

TIP

- Align the match marks “a” on the handlebar with the upper surface of the lower handlebar holder.
- The upper handlebar holders should be installed with the arrow marks “b” facing forward “A”.

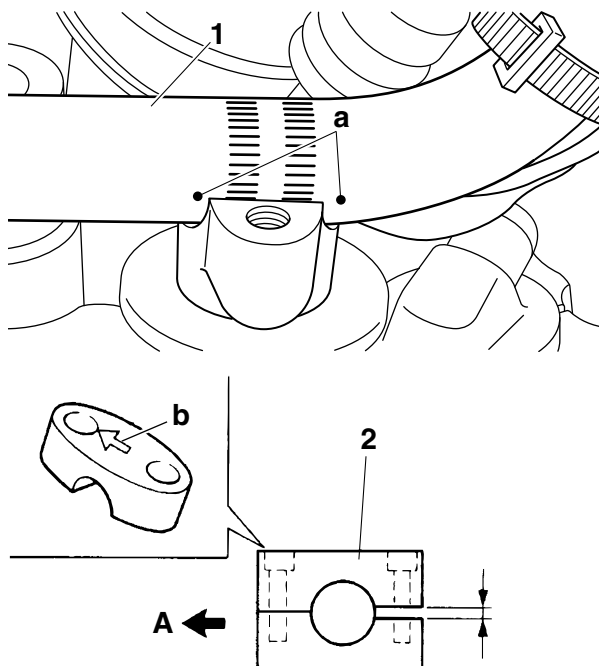

3. Install:

- Throttle grip
- Throttle cable

TIP

Lubricate the inside of the throttle grip with a thin coat of lithium-soap-based grease and install it onto the handlebar.

4. Install:

- Right handlebar switch “1”
- Brake master cylinder “2”
- Brake master cylinder holder “3”

Refer to “INSTALLING THE FRONT BRAKE